

AUTOWORKS INTERNATIONAL

64-70 MUSTANG POWER DOOR LATCH INSTALL INSTRUCTIONS



THIS KIT CONTAINS:

- (1) LH Mustang Door Lock/Latch w/ Motor
- (1) RH Mustang Door Lock/Latch w/ Motor

Optional

Deluxe Hardware Install Kit:

- (6) Door Lock Rod Retainers
- (6) Door Latch Screws

Additional Door Hardware:

- (2) Control Rods
- (6) Lock Rods
- (2) Door Lock Knobs

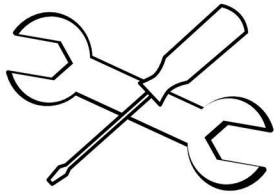

Here's What You'll Need:

- 1..... Large "philips" screw driver
- 2..... 1/2" Socket
- 3..... 7/16" Socket
- 4..... Various Length Socket Extensions
- 5.....Ratchet Wrench
- 6.....Small "Flat Head" Screw Driver or another small prying tool
- 7..... Any safety equipment you deem necessary such as gloves and goggles.

*****IMPORTANT*****

These latches do not come pre-lubricated. Use Engine Oil or a light lubricating fluid.
Do NOT use lithium or spray grease

64-66 Mustang Door Latch & Handle Assembly

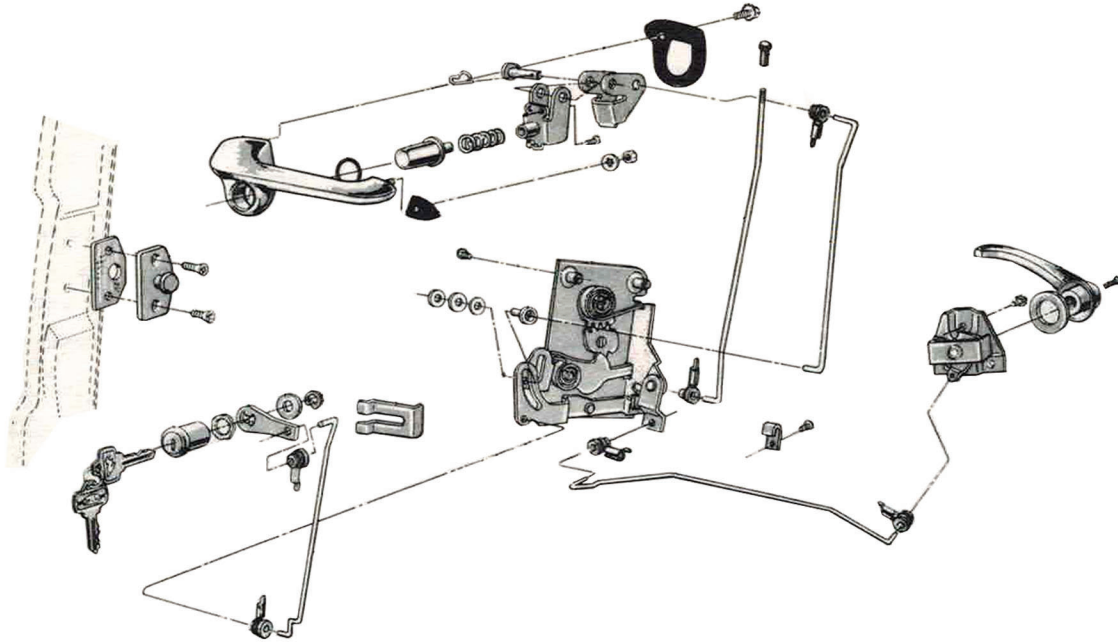

67-70 Mustang Door Latch & Handle Assembly

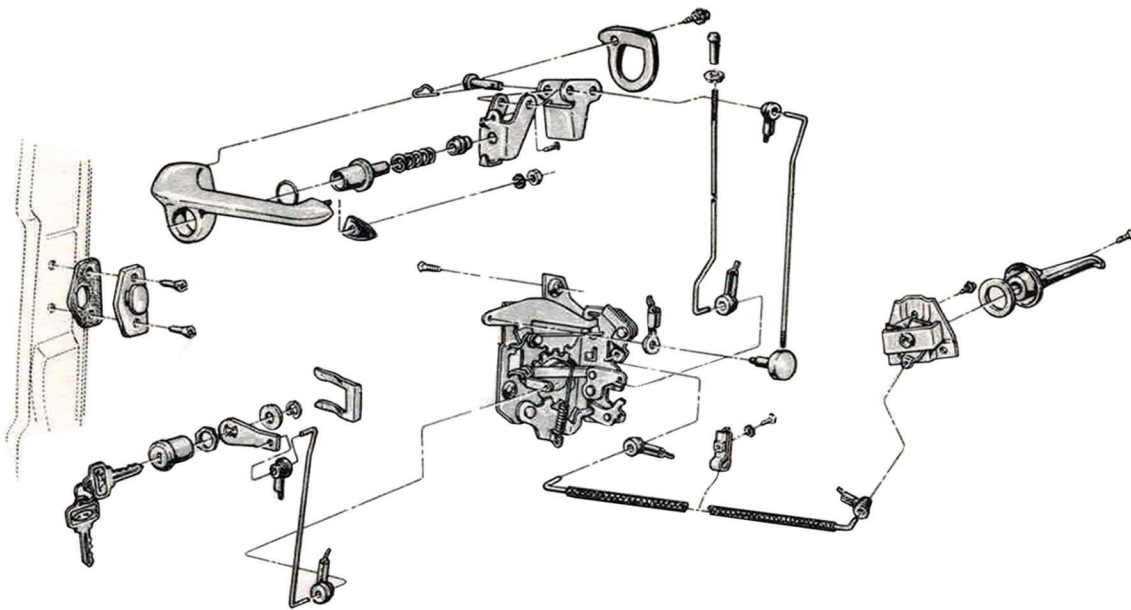

*Illustrations by Ford Motor Company

PHASE 1: DOOR PANEL & LATCH REMOVAL

1. Remove the Door Window Crank & Door Pull
 - a. Roll the window all the way up
 - b. Remove the window handle screw and withdraw the handle
 - c. Remove the Retainer Screw from the Door Pull and remove Door Pull

2. Remove the Door Panel and Watershield
 - a. Remove the trim panel retaining screws and then pry the panel retaining clips out of the inner panel and remove the panel.
 - b. Remove the watershield to expose the inner door shell.

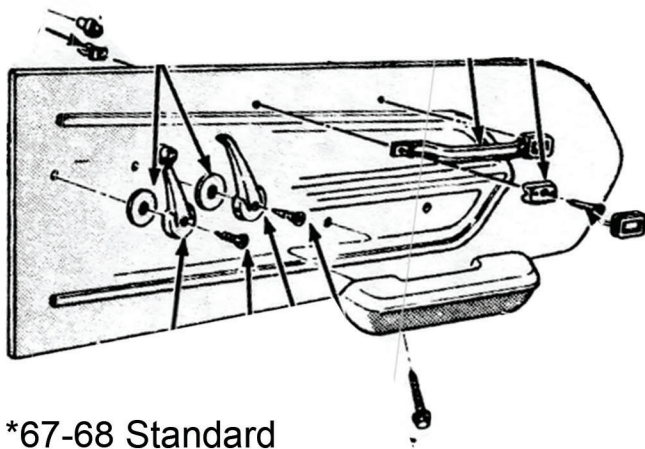

*67-68 Standard

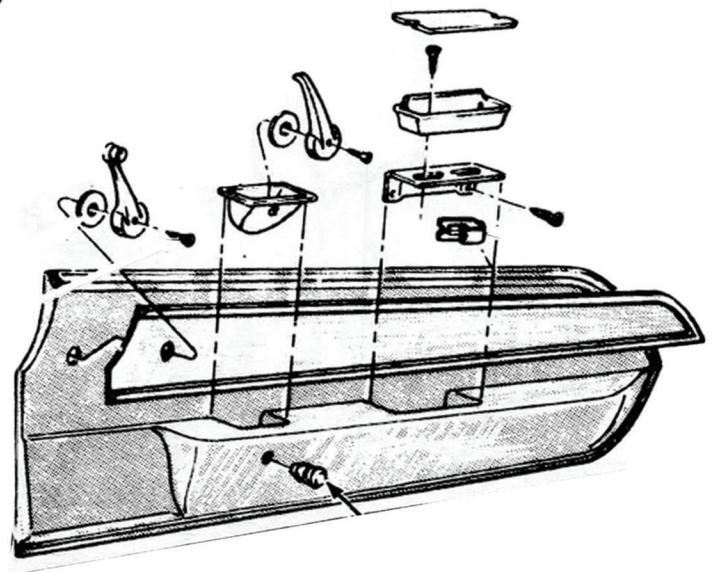

*67-68 Deluxe

PHASE 1 CONTINUED

3. Remove the 4 Rods from the latching assembly.
 - a. Use a Flat Head screw driver to pry the Latch Rod Retainers from their mounting points on the latch. If you did not purchase our Hardware Install Kit then we recommend being careful to not damage them.

****NOTE**** It'd be smart to note which rod connects to which part of the latch. We recommend tagging and labeling each rod so you know where to reconnect each rod when installing the new Power Latches.

- b. Undo the 3 screws that hold the latch to the door assembly from outside the door shell
- c. Remove the Latch Rod Retaining Clips from the Latch if you are reusing them. Otherwise discard.
- d. Remove the "Door Open" warning switch from the latch.

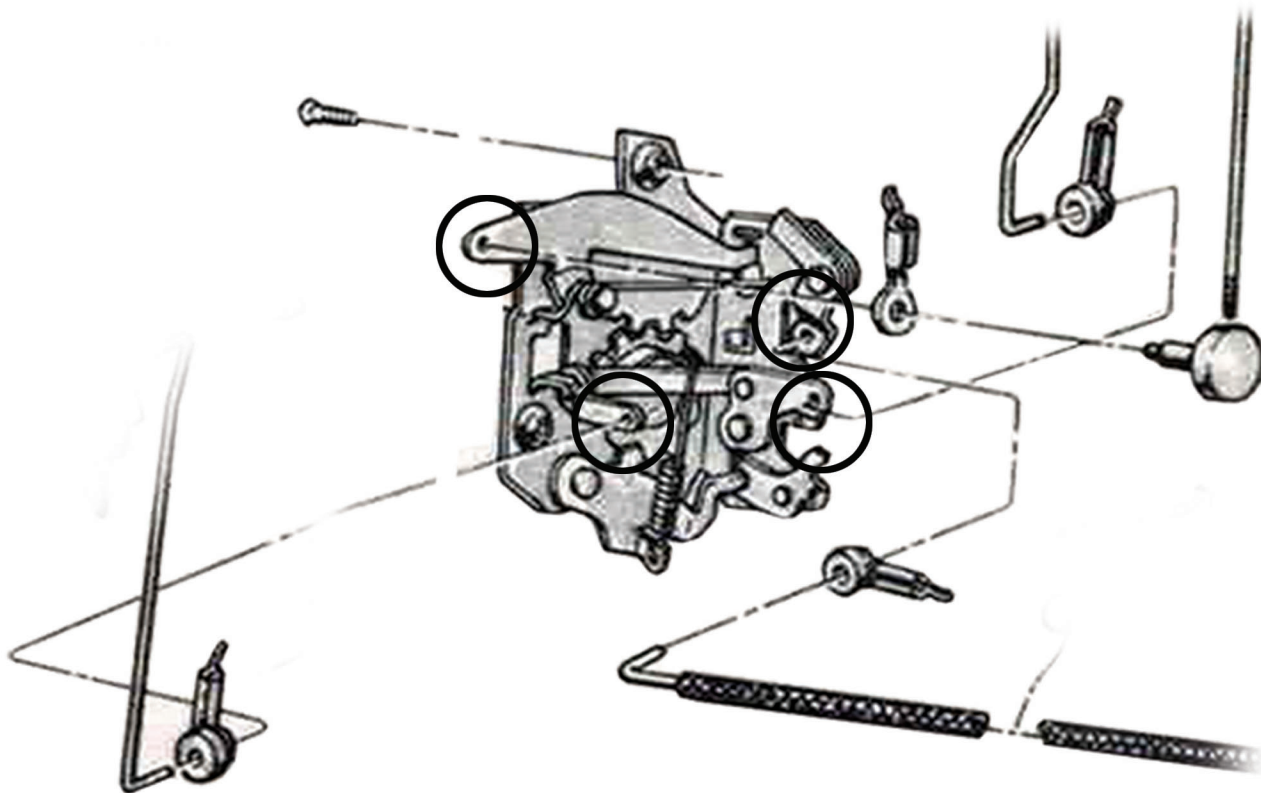

PHASE 2: POWER DOOR LATCH INSTALLATION

1. Install your new or existing Latch Rod Retainers onto your new Power Door Latches.
 2. Install the “Door Open” warning switch onto your new Power Door Latches and adjust it.
 - a. Loosen the switch attachment screw and set the door latch in the closed position
 - b. Position the switch contact near the latch cam but not touching it, then tighten the switch attachment screw.
 - c. Set the door latch for the safety and open positions. The switch contact must make electrical contact with the cam when the latch is in the safety and open positions.
 3. Grease the new Power Door Latch assembly with RED or WHITE grease. An ungreased latch will fail and will not be warrantied.
 4. Maneuver the latch around the window track and reconnect the 4 rods, starting on the inner door handle rods and working your way to the outer door handle rods.
- **NOTE**** Your Door Latch Actuating Rod may need adjustment. If so, disconnect the Latch Actuating Rod from the Latch Actuating Lever. Adjust the length of the rod. Reinstall the Latch Actuating Rod to the Lever and fit the Retaining Clip. Check the operating of the Outer Door Handle Push Button and adjust more if needed.
5. Run the wiring from the latches through the front pillar of the door. Additional length wiring is not included in your kit and must be installer supplied.
- **NOTE**** Deluxe Interior cars will already have an access hole at the front of the door to run your wiring through. Non Deluxe interiors will require you to cut an access hole. Always line your access hole with an appropriate grommet to avoid damaging your wire.
6. Connect to power source, test and enjoy. Please refer to our wiring diagrams. If you purchased our Keyless Entry with your kit, then follow the diagrams listed in this guide. Otherwise, refer to the user manual on your keyless entry/alarm
 7. Follow Phase I in reverse to reinstall your door panel and handles.

Autoworks International, LLC

Power Door Latch to Keyless Entry/Switch Diagram

FOR POWER DOOR LATCHES WIRED TO SWITCHES

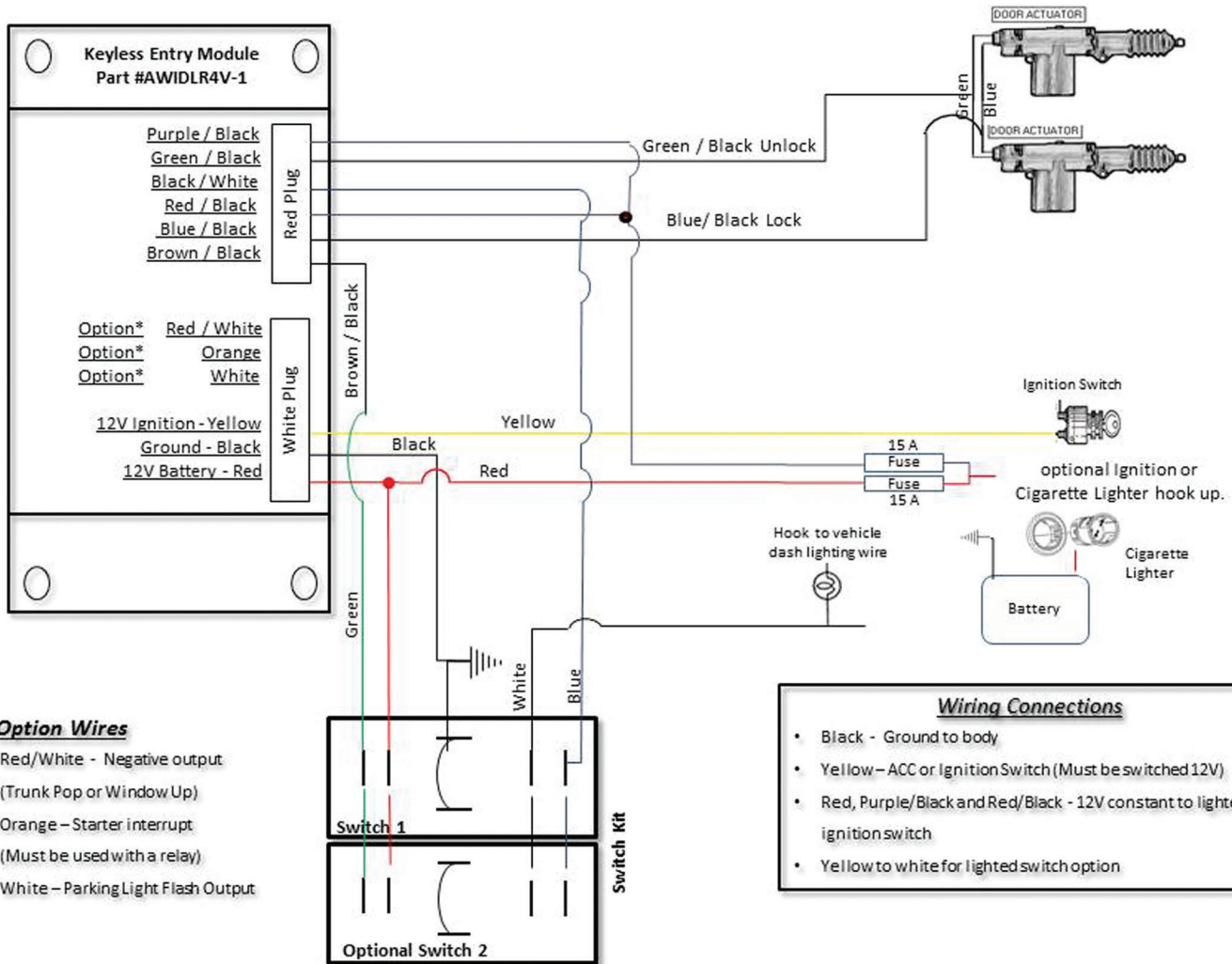

*** Option Wires**

- Red/White - Negative output (Trunk Pop or Window Up)
- Orange - Starter interrupt (Must be used with a relay)
- White - Parking Light Flash Output

Autoworks International, LLC

Power Door Latch to Keyless Entry/Switch Diagram

FOR POWER DOOR LATCHES WITH NO SWITCHES

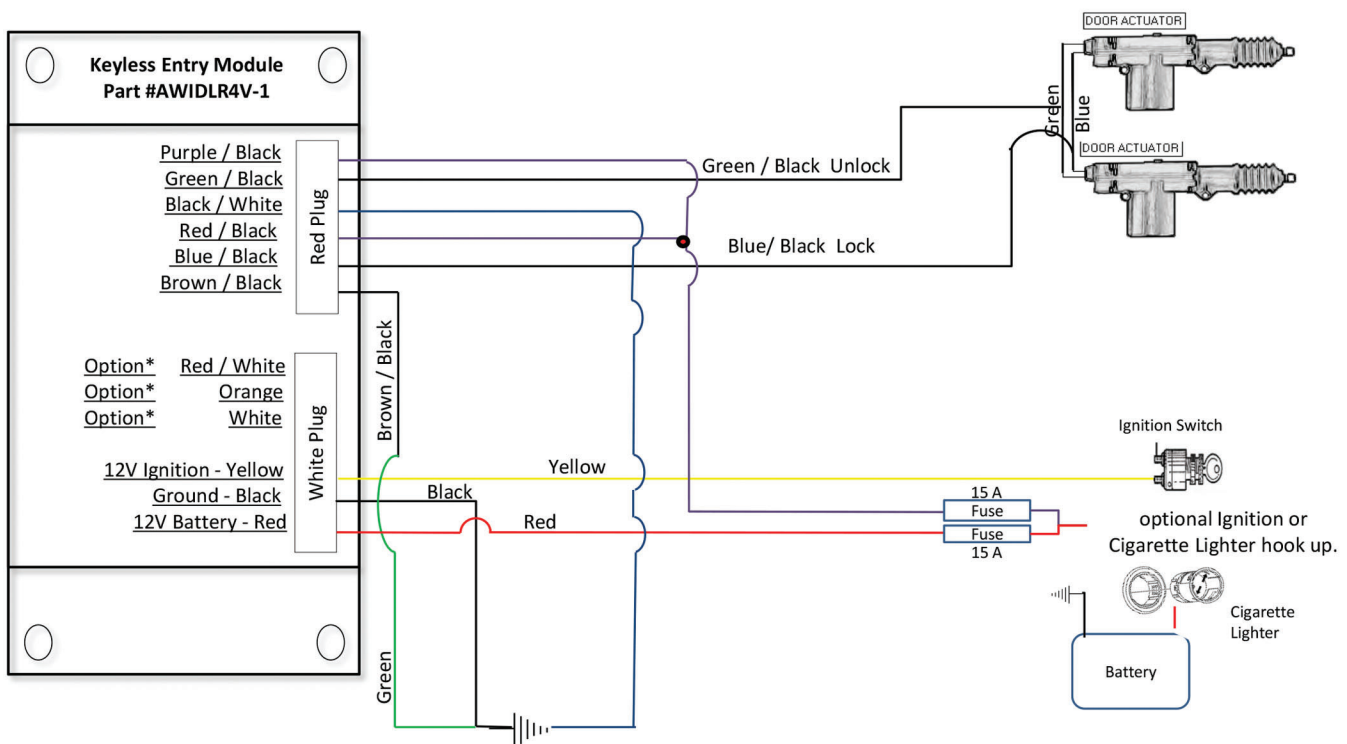

* Option Wires

- Red/White - Negative output (Trunk Pop or Window Up)
- Orange - Starter interrupt (Must be used with a relay)
- White - Parking Light Flash Output

Wiring Connections

- Black - Ground to body
- Yellow - ACC or Ignition Switch (Must be switched 12V)
- Red, Purple/Black and Red/Black - 12V constant to lighter or ignition switch
- Yellow to white for lighted switch option