



IKKEY

PREMIER

INTELLIGENT KEYLESS IGNITION



User Guide

Table of Contents

iKey Overview	2
Important User Information	3
iKey Fob Operation	3
Proximity Door Unlock / Alarm Disarm	3
Proximity Door Lock / Alarm Arming	3
Auxiliary Channels	4
Remote Trunk Release	4
Panic Function	4
Valet mode	4
Built in Door Key	4
Emergency Bypass Card	5
Start Button Operation	5
Standard Start / Stop Method	5
Emergency Start / Stop Method	5
One Touch Start / Stop Method	5
Diesel Vehicles Standard Start	5
Start Button LED Functions	6
Status LED Functions	6
Security and Alarm Features	6
Horn or Siren Selection	6
Shock Sensor	7
Door-Not-Closed Reminder	7
Ignition Controlled Door Lock/Unlock Function	7
Key-Not-Found Reminder	7
Auto Window Closing	7
User Programmable Features	8
Remote Start with One Touch Starting	9
One Touch Starting	9
Remote Start Operation	9
Remote Start Ignition Takeover Procedure	9
Vehicle Battery Power Saver Function	9
Vehicles with Shaved Doors & Poppers	10
“PKE OFF Permanent” mode	10
Operation of Features in “PKE OFF Permanent” mode	10
iKey Fob & Emergency Bypass Card Programming	11
Entering Programming Mode	11
Programming iKey Fobs and Emergency Bypass Cards	11
Optional Guard Dawg Tracker 4G GPS system	11
iKey Fob Battery Replacement	11
Warranty and Registration	12



Congratulations on your purchase of the iKey Premier Keyless Ignition System. Digital Guard Dawg products are proudly manufactured to the highest quality standards by people who really care. We use only premium materials and electronic components to ensure you a product of excellent performance and superior life. We hope you enjoy a genuine sense of excitement and security from owning the Digital Guard Dawg iKey.

Many Thanks,

“The Guard Dawg Gang”

iKey Overview

The iKey is the most advanced RFID Keyless system available today. This OEM quality system fully replicates the complete keyless operation found on today's most advanced luxury vehicles. iKey combines “Hands Free” Keyless Access, Keyless Security and Keyless Ignition all into one system. Now you can “Go Keyless” with any vehicle you own! The iKey uses advanced RFID (Radio Frequency Identification) technology from Texas Instruments®, to provide you the ultimate in convenience and protection for your vehicle. No more frustration from searching or fumbling around with keys or remotes. You simply place one of the systems RFID key fobs in your pocket or purse. As you approach your vehicle, your RFID key fob is detected and your vehicles doors instantly unlock. Just climb in, and with a push of the Start Button your engine roars to life! When you exit your vehicle, you just walk away. . . . As you leave the systems sensing range, your doors will automatically lock and iKey's advanced two stage security system will self-arm leaving your vehicle securely protected. It's Impossible to forget to protect your vehicle! Each iKey system can learn up to 4 key fobs and 2 Bypass cards.



As you approach your vehicle, your RFID key fob is detected and your vehicles doors instantly unlock. Just climb in, and with a push of the Start Button your engine roars to life! When you exit your vehicle, you just walk away. . . . As you leave the systems sensing range, your doors will automatically lock and iKey's advanced two stage security system will self-arm leaving your vehicle securely protected. It's Impossible to forget to protect your vehicle! Each iKey system can learn up to 4 key fobs and 2 Bypass cards.

Got multiple vehicles? With the iKey you can operate an unlimited number of vehicles using just one iKey Fob!

iKey is also available with optional Remote Start to warm your car in the winter or cool it down in the summer.

Didn't get Remote Start when you purchased your system? It's never too late!

Just give us a call at 877-246-5395.

Losing Your Keys Never Felt So Good!

Important User Information

- Do not leave the ikey transmitter in close proximity to electromagnetic devices such as mobile phone network devices or microwaves
- Do not leave the ikey transmitter in high temperatures for excessive periods of time such as on the dash or in direct sunlight
- Do not expose or submerge the ikey transmitter in liquid, if it occurs, remove battery from the iKey immediately and dry the circuit board for a few days prior to reinserting battery
- This system is susceptible to interference caused by high voltage power lines cellular and broadcasting stations or other high frequency electronic devices
- Do not modify remove or disassemble the original system. If any unauthorized modifications are made the proper operation of the system cannot be guaranteed and warranty will be void
- Do not leave the iKey fob in the vehicle for extended periods when the vehicle is not being operated.

iKey Fob Operation

Your iKey Fob uses the latest advances in **RFID (Radio Frequency IDentification)** technology to deliver a level of security even better than many factory keyless systems. The iKey™ operates using our exclusive **DFDE (Dual Frequency ~ Dual Encryption)** communication technology. Each iKey™ is completely unique, with one of over 6 billion different codes. The iKey Fob operates 6 independent channels allowing you to control an almost endless combination of accessories, such as Door Locks, Trunk Release, Power Windows, Remote Start, Power Sunroof, Convertible Tops, Lighting or Audio systems all from a single remote.

Your iKey Fob is both a Passive (*automatic*) and Active (*manual*) operating device. **PKE (Passive Keyless Entry)** operation includes unlocking your doors and disarming your alarm as you approach, then locking doors and arming your alarm when you exit, all done automatically without ever pushing any buttons. Active operations include: Extended Range Lock and Unlock, Trunk Pop, Remote Starting, plus whatever additional accessories you add to Aux channels 1 & 2.



Additional Functions

- AUX 1 Trunk first then Unlock
- AUX 2 Trunk first then Lock
- REMOTE START Trunk + Lock for 3 Sec
- PANIC Lock for 3 Seconds

Proximity Door Unlock / Alarm Disarm

Approach the vehicle, as the iKey fob enters the sensing range, the system will Disarm and Unlock the doors immediately. If the Horn is enabled, the parking lights will flash 2 times. If the Siren is enabled, the parking lights and siren will both flash and sound 2 times. The status LED indicator light will flash BLUE to indicate the system is now Authorized & Disarmed

Proximity Door Lock / Alarm Arming

Walk away from the vehicle, as soon as the iKey exits the sensing range, the system will automatically Arm and Lock the doors immediately. If the horn is enabled, the parking lights will flash 1 time. If the siren is enabled, the parking lights and siren will flash and sound 1 time. The Status LED indicator light will flash BLUE and RED alternatively to indicate the system is armed. * When the iKey fob is within sensing range you can press and hold the LOCK button for 3 seconds to override automatic Unlock function and manually lock the doors

Note: The Doors will not be unlocked again until the iKey exits and re-enters the sensing range. ****DO NOT LEAVE IKEYS INSIDE THE VEHICLE WHEN NOT PRESENT**

Auxiliary Channels

The iKey system allows you to control 2 additional output channels, Aux 1 & Aux 2 via the iKey fob.

Press TRUNK button first then press the UNLOCK button to activate AUX 1 output

Press TRUNK button first then press LOCK button to activate AUX 2 output

These outputs will work while the ignition is in the OFF, ACC or ON positions, but not work while the engine is running. These outputs provide a 1 second ground pulse to the Aux 1 & Aux 2 outputs

Remote Trunk Release

To release the Trunk, press and hold the Trunk Release button for 3 seconds. Note, the system will unlock and disarm the vehicle before opening the trunk. Make sure to close the trunk when done. Once the iKey fob is outside the proximity sensing range, the doors will re-lock 60 seconds later as long as all the doors and trunk are closed. While the engine is running or the ignition is in ACC or ON state, the trunk release output will be deactivated.

Panic Function

While the iKey is outside the proximity sensing range: Press and hold the LOCK button for 3 seconds to activate the Panic Function. The parking lights will flash and horn/siren (if enabled) will sound for 30 seconds. If the vehicle was remotely started, the engine will shut down immediately. Press LOCK or UNLOCK button to exit the Panic Function

Valet mode *(Passive Entry OFF Temporarily)*

The iKey Fob can be easily switched into "Valet" mode for car washing, vehicle repairs, etc.

This feature allows you to temporarily turn OFF the passive Door Lock/Unlock & Alarm functions.

While in "Valet" mode the doors will not lock automatically and Alarm will not automatically Arm.

To Turn ON Valet mode: *(LED Status is Solid BLUE)*

System must first be "Authorized" (either by coming into vehicle proximity or pushing the Unlock button) next, push both Lock + Unlock fob buttons together for 3 seconds.

The system will sound 2 Chirps when passive Lock & Unlock is turned "OFF" and 1 Chirp when it is turned back ON. Valet Mode also deactivates the systems alarm functions and will not rearm after 60 seconds.

Built in Door Key

Just in case you every find yourself with a dead vehicle battery, you can still always unlock your doors.

Tucked inside the iKey fob is a hidden compartment that can hold a spare door key blade. Just get a standard spare key cut and insert it into the cavity as shown below.

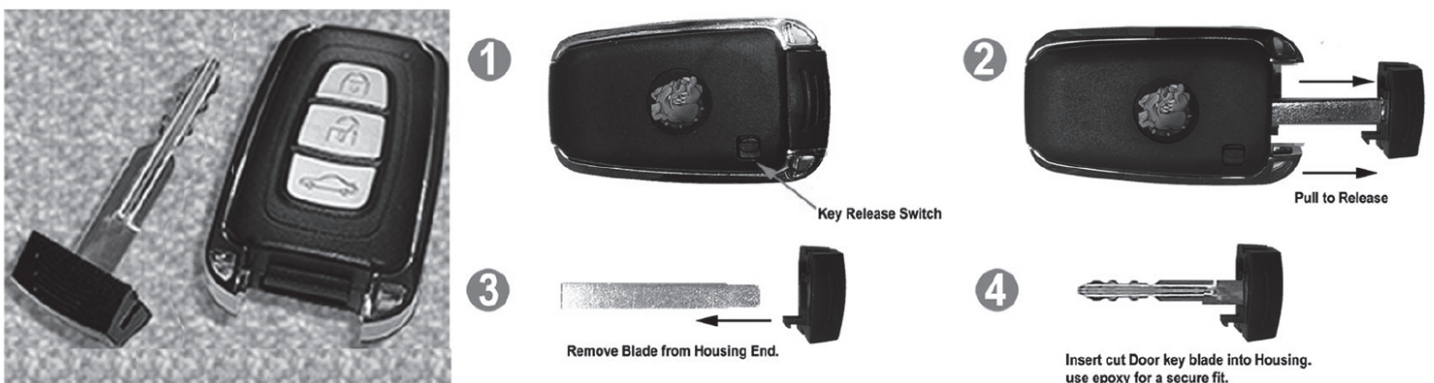

Emergency Bypass Card



Should you ever lose or damage your Key fob, the system includes an Emergency Bypass Card to always guarantee you access to your vehicle. This is the same “passive RFID” technology used for access of high security buildings. Just hold the Bypass Card next to your Bypass Antenna for 10 seconds and the doors will unlock and you will be able to start your engine. Emergency Bypass Cards are completely waterproof and use no batteries making them perfect as a backup access device. The typical location for mounting the systems Bypass Antenna is on the glass where the windshield meets the dash of the driver side of the vehicle. Once the Emergency Card is removed from the bypass antenna, the system will lock and arm after 30 seconds. You must enter and start the vehicle within this 30-second window to avoid triggering the alarm. If a longer disarm time is required leave the Emergency Card on top of the bypass antenna to disarm continuously.

Note: After driving with the Emergency Card, turn off the ignition, the Start Button will be deactivated after 10 seconds. The Key-Not-Found Reminder Function will be activated while driving with the Emergency Card.

START BUTTON OPERATION

Standard Start / Stop Method:

To Start the Engine:

Depress the Brake Pedal, *(Depress Clutch if selected @Jumper J1)*
The Start Buttons LED will begin flashing, indicating the system is ready to start.

Press and Hold the Start Button until the Engine Starts.

To Turn the Engine OFF:

Depress the Brake,
Press the Start Button and the Engine turns OFF

Emergency Start / Stop Method *(Brake / Clutch Override)*

If necessary, you can Start or Stop the engine without using the Brake or Clutch by depressing and holding the Start Button for 3 seconds. *** **Caution: In a manual transmission vehicle, this method could result in cranking the engine while in gear if you have not yet installed a Neutral Safety Switch.**

One Touch Start / Stop Method: *(Included with the optional Remote Start package)*

To Start the Engine:

Depress the Brake Pedal, *(Automatic Transmissions Only)*
The Start Buttons LED will begin flashing, indicating the system is ready to Start.
Push and Release the Start Button, the Starter will crank until the engine is started.

To Turn the Engine OFF:

Depress the Brake,
Press the Start Button, Engine turns OFF

Diesel Vehicles: Press and release the Start Button 1 time. When the Glow Plug Light goes out, depress the Brake, then press-and-hold the start button to START the vehicle.



START BUTTON LED FUNCTIONS

Note: This diagram is to reference the LED positions of the Slim line series Start Buttons only. If you have another style of Start Button, your LED layout may be different. Some Billet style Start Buttons have only one LED of a single color.



START BUTTON LED	RING LED	OVAL LED	BACK LIGHT
AUTHORIZED	ON	OFF	ON
ACCESSORY 1 ON	OFF	ON	ON
ACC 1&2+ IGNITION ON	ON	ON	ON
BRAKE DEPRESSED	FLASH	OFF	ON
RUN MODE	OFF	OFF	ON

STATUS LED Dual Color

The system Status LED provides visual indication to would be thieves that your vehicle is protected. The LED can flash Red, Blue, Purple as well as several combinations of sequences, Red, Red, Blue, etc. Using these colors and sequences, the Status LED gives you continual indication of the iKey's operating status, letting you know important information such as which system features are turned ON or OFF or if a violation has occurred while you were away. Although not required, it is highly recommended that the LED be mounted where it can be viewed from both inside and outside the vehicle. The chart below shows the different LED Status Modes.

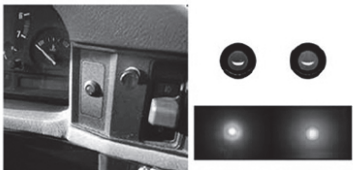

Dash Mounted Status LED

FEATURE POSITION	DISARMED	ARMED	ALARMING	ALARM NOTIFICATION
PKE ON	Blue / Blue / Blue	Blue / Red / Blue	Red / Red / FAST	Red / Red / SLOW
PKE PERMANENTLY OFF	Blue / Blue / Blue	Purple / Purple	Red / Red / FAST	Red / Red / SLOW
VALET MODE	Solid Blue	Solid Blue	N/A	N/A
ALARM OFF	Blue / Blue / Blue	Red / Red / Blue / Blue	N/A	N/A
ALARM OFF + VALET	Solid Blue	Solid Blue	N/A	N/A
ALARM OFF + PKE OFF	Slow Blue	Red / Red / Blue	N/A	N/A

* While iKey fob is out of sensing range and system is waiting to rearm LED will flash Red /Blue/Red/Blue

SECURITY & ALARM FEATURES

The iKey Security & Alarm function monitors the shock sensor, door switch, hood pin, brake and ignition while the system is in the armed state. If the alarm is triggered, the alarm will sound the horn (or siren if installed) and flash the parking lights for 30 seconds. The Status LED will flash Red upon disarm to notify the driver that the alarm function was triggered while away.

Note: Alarm functions can be Enabled or Disabled via DIP Switch 2

If the Alarm function is active:

All Sensors will arm 5 seconds after the iKey fob leaves proximity.
The Siren / Horn will sound when the shock sensor, door, hood and ignition triggered.

If the Alarm function is disabled:

LED flashes RED-RED-BLUE
The alarm will not sound when the shock sensor, door, hood and ignition triggered.
The Push-Start system will function normally by iKEY fob proximity.
After the alarm function is disabled, the security LED will flash purple when armed.

Horn or Siren Selection

DIP Switch 4 default is set to have the horn output muted when locking and unlocking the doors. The horn output will only sound when the system has seen an alarm violation or when it is in programming modes. If you desire audible notifications for system arming status (locking and unlocking) a siren can be connected to the horn output and change DIP Switch 4 to the Down position.

Shock Sensor Dual Stage

This sensor monitors your vehicle for attempted intrusion and impact. Any impact to your car while the alarm is armed will trigger the shock sensor to respond. It is typically mounted with a zip tie to the steering column. This sensor has dual level of detection, Depending on the severity of the shock, the iKey will react to a full shock by triggering the alarm function (the horn sounds and the parking lights flash for 30 seconds) or respond to a lighter shock (30% of the strength of a full shock) by giving a warn-away alarm by a short honk and flashing the parking lights 5 times. To cancel a shock triggered alarm activation, approach the vehicle with the iKey fob or press LOCK or UNLOCK button.

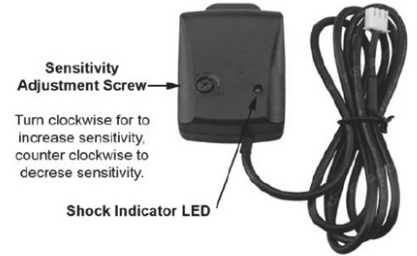

To Set the Sensitivity: Arm the system, then thump moderately on the front fender of the vehicle with your hand and trigger the "Warn Away" chirps. A second hard thump should trigger a full alarming sequence. Use the Adjustment screw to set up the correct sensitivity for your vehicle.

Door-Not-Closed Reminder (Default is ON)

Leaving the iKey sensing range with the doors open or ajar will trigger the **Door Not Closed Reminder**. The vehicle will give three sets of 2 chirps and flash the parking lights to warn the driver that one or more doors are not closed. If the doors remain open after the warning, the system will lock the doors regardless. The parking lights will continue to flash for additional two (2) minutes however, the vehicle will be armed and the engine Start Button will be disabled.

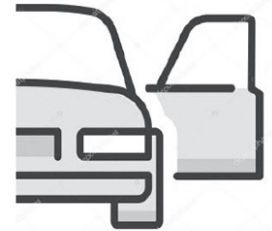

To disable/enable the Door-Not-Closed Reminder (Default is ON)

With the door open, switch the ignition to ACC, depress and hold the brake pedal then press and hold the TRUNK button and UNLOCK button together for 2 seconds until the horn honks. The vehicle will honk once if function is enabled or twice if disabled.

Ignition Controlled Door Lock / Unlock Function (Default is ON)

Ignition Controlled lock function will automatically lock the doors when the brake is applied 15 seconds after the vehicle is started. The doors will automatically unlock when the ignition is turned OFF. The default setting of this function is ON.

To disable/enable the Ignition-Controlled Door Lock feature: While the alarm is disarmed with ignition OFF, do not depress the brake, push the Start Button twice to turn the ignition ON, then depress and release the brake pedal 6 times within 10 seconds, the horn will honk twice to confirm. Repeat the operation to enable this function, the horn will honk 1 time to confirm feature is enabled and 2 times if disabled.



Doors automatically unlock when the ignition is turned OFF



Key-Not-Found Reminder (Default is ON)

(If the iKey fob leaves sensing range while the vehicle is running)

If the vehicle door is opened-then-closed while the vehicle is running, the next time the brake is applied; it will trigger the system to verify that the iKey fob is still in the vehicle. If the iKey fob is found the search will end, but If the iKey fob is not located, the system will alert you with three sets of 2 chirps and parking light flashes. This is to remind you that the iKey is no longer detected and it needs to be present in the vehicle before it is driven to another location. Without the iKey, once the vehicle is turned off it will not be able to start again. However the bypass transponder can be used for start in this case.



To disable/enable this function: With the door open, switch the ignition to ACC, depress the brake pedal, then press and hold the TRUNK button and LOCK button together for 2 seconds until the horn honks. The horn will honk 1 time if function is enabled or 2 times if disabled.

Auto Window Closing (Additional Window Roll Up Module needed)

The iKey can automatically close your vehicles windows when you exit. Simply add a Window Roll up module. Windows and sunroof left open will automatically close in sequence when the vehicle is armed / locked. Window Rollup modules can be purchased at www.DigitalGuardDawg.com Click Products / Accessories



USER SELECTABLE FEATURES

The iKey has a series of user selectable features that can be turned ON or OFF to customize the systems functions to your individual needs and wants. The diagram belows shows selectable feature options. These are typically set up at the time of install, but can be changed at any time. **IMPORTANT: You MUST remove power from the system prior to changing any Dip Switch or Jumper settings.**

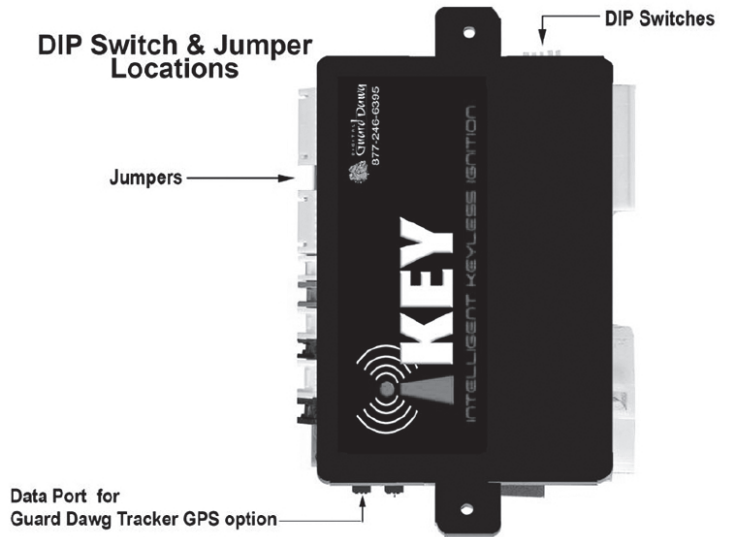

DIP SWITCHES

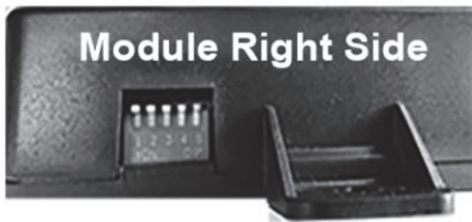

JUMPERS



DOME DELAY OFF Up / ON Down	5
HORN Up / SIREN Down	4
Door Lk 1 Pulse Up / 2 Pulse Down	3
ALARM ON Up / OFF Down	2
PKE ON Up / OFF Down	1

Switch

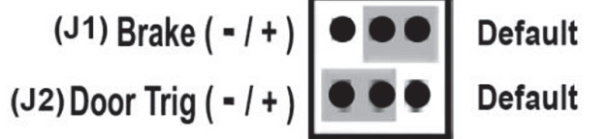

REMOTE START with One Touch Starting *(Upgrade if Purchased)*



One Touch Starting

This feature allows you to start your vehicle with just one quick push of the Start Button.

The iKey will crank your starter just long enough to assure your engine is started.

Remote Start Operation

Now with just a press on your iKey fob you can remotely start your engine to warm your vehicle on the winter or cool it down in the summer. With the iKey outside the proximity sensing range, press and hold the TRUNK RELEASE and LOCK buttons together for 3 seconds. The parking lights and siren (if enabled) will flash and sound 1 time to indicate remote start signal received. After 5 seconds the system will attempt to start the engine. If the vehicle does not start at the first attempt (i.e. cold engine), the iKey will attempt to start the engine up to 3 times. Once started the vehicle will run for 15 minutes. Parking lights will remain ON during this period.



Remote Start Ignition Takeover Procedure

After the vehicle is remote started, use the following steps to take over the ignition without restarting the engine: Approach the running vehicle with a valid iKey fob to disarm the alarm and unlock the doors. Enter the vehicle and without stepping on the brake, press the Start button once. Step on the brake to exit Remote Start mode. (Status LED turns OFF) Vehicle is now safe to take out of the park to drive.

Additional Information about Remote Starting

- To shut down the remote start, press and hold the TRUNK RELEASE and LOCK buttons again for 3 seconds.
- For diesel vehicle there will be a delay while the vehicle's Wait-to-Start Light is ON. Starting will begin when the light goes off or after 18 seconds the system will proceed to start the engine regardless.
- The engine will shut down remote start after 15 minutes or if the RPM is too high. *(Example: If floor mat got stuck on the gas pedal.)*

*** If you didn't purchase the Remote Start Option when you purchased the iKey,**

It's never too late to upgrade! Just call 877-246-5395

Vehicle Battery Power Saver Function

The iKey will reduce its search frequency after 7 days of inactivity to conserve the vehicles battery. Should you be away from or not use your vehicle for more than 7 days, the iKEY fob sensitivity will be reduced and it will take slightly longer (8-10 seconds) to automatically identify the iKey or the Bypass Transponder Card. After 10 days of no use you may need to press the UNLOCK button once to wake up the system. Once woken up the iKey will exit the Power Saver mode and resume normal operation.



Vehicles with Shaved Doors and Poppers

PKE OFF “PERMANENT” mode:

DIP Switch 1 DOWN

LED: PURPLE / PURPLE

With Resto Mod blood pumping in its veins, the iKey is ready for any customizing challenge. Simply change the setting of DIP Switch 1 to Down to put the iKey in **PKE OFF “PERMANENT” mode**. The iKey will customize its feature groups to operate specifically for vehicles with Shaved Door & Poppers. When this feature is selected, the Lock and Unlock Buttons automatically reassign to “Drivers” Door and “Passengers” Door operation. The iKey’s Alarm functions will now disarm upon seeing either door opened, but keep your vehicle secure by not authorizing the Start Button until the iKey fob comes into range. The alarm now rearms 1 minute after the iKey fob leaves proximity. When out of proximity range; If either the **Unlock / Lock / Trunk / Aux 1 or Aux 2** buttons are pressed the Alarm Disarms, which allows you to operate any combination of accessories without triggering an alarm violation. If no iKey fob enters proximity within 60 seconds the alarm automatically rearms. If a door is accidentally left open, the system will send a Door Open Notification of three sets of 2 Chirps, 15 seconds after the fob leaves proximity. Note: Alternatively, doors can be assigned to Aux 1 or 2

To Remote Start your vehicle in “PKE OFF PERMANENT” mode, the system must have Armed for 1 minute prior to attempting to Remote Start.

Operation of Features in “PKE OFF PERMANENT” mode:

Remote Start

Press the **Trunk** and **Lock** buttons both at the same time, hold for 3 Seconds.
The system must have Armed for 1 minute prior to attempting to Remote Start.

Remote Trunk Release

Press and hold for 3 Seconds.
Doors will not open,
Alarm will Disarm, and then Rearm 1 minute after the iKey fob leaves proximity.
Ignition will not authorize until you enter vehicle proximity.

AUX Channels 1

To activate the **Aux 1** channel output, press the Trunk button first, and then press the Unlock button.
Alarm will Disarm, and then Rearm 1 minute after key fob leaves vehicle proximity.
Ignition will not authorize until you enter vehicle proximity.

AUX Channels 2

To activate the **Aux 2** channel output, press the Trunk button first, and then press the Lock button.
Alarm will Disarm, and then Rearm 1 minute after key fob leaves vehicle proximity.
Ignition will not authorize until you enter vehicle proximity.

iKey Fob & Emergency Bypass Card Programming

Use the following procedures to program a new set of iKey fobs and/or Emergency Bypass Cards.

All iKey Fobs and the Emergency Bypass Cards must be present and accessible during programming.

Entering Programming Mode

Method 1: If you still have a Valid iKEY Fob

Disarm the system with a valid iKey Fob.

Switch ignition to ACC, depress and release the brake pedal 3 times then press and release the UNLOCK button on a valid iKey fob 3 times, the horn/siren will chirp 3 times, the system's Red/Blue status LED will turn solid Red indicating the system has entered **iKey Programming mode**.

Method 2: If you do not have a Valid iKEY Fob

Disarm the system with your Emergency Bypass Card.

Switch ignition to ACC, depress and release the brake pedal 3 times then press and release the UNLOCK button on the Replacement iKey fob 3 times, the horn/siren will chirp 3 times, the system's Red/Blue status LED will turn solid Red indicating the system has entered **iKey Programming mode**.

Programming iKey Fobs and Emergency Bypass Cards

Once the system is in iKey programming mode, press and holds the LOCK button on the 1st iKey transmitter for 3 seconds until the horn honks once. Then within 10 seconds repeat the same procedure for the 2nd, 3rd or 4th iKey transmitter, the horn will honk 2, 3, or 4 times indicating how many Key fobs have been entered into the systems memory. **Next the status LED will turn Blue**, indicating the system is ready to learn the Emergency Bypass Cards. Within 10 seconds hold the 1st Bypass Card to the Bypass antenna until the horn honks once. Then hold the 2nd Bypass Card to the Bypass antenna, the horn honks twice. Wait for 3 seconds, the horn will honk 5 times as the system exits programming mode.

GPS DATA PORT

This port is for adding a 4G GPS Guard Dawg Tracker system. The Guard Dawg 4G Tracker's advanced design provides the highest level of Protection and most reliable 4G tracking money can buy! Always know where your vehicle is and monitor its condition at all times. If it's ever stolen, the Guard Dawg 4G Satellite Tracker will help you and law enforcement recover it quickly.

For information go to: www.DigitalGuardDawg.com or call 877-246-5395

iKey Fob Battery Replacement

iKey Fob batteries should be replaced at least once per year or whenever the proximity range of the system seems decreased. Short proximity range is the first sign a low fob battery. IKey Fobs use a commonly available CR-2032 Lithium Coin battery. Due to the lengthy time batteries can sit on a warehouse shelf, it is always advisable to test even new batteries of this type with a voltage meter to confirm good voltage. These batteries should test above 3.2 volts out of the package and are considered dead even at 2.9 volts.



Warranty Registration

Be sure and register your Digital Guard Dawg system on line at www.DGDwarranty.com

WARRANTY

This warranty from the manufacturer Digital Guard Dawg, Inc. ("DGD") warrants the original purchaser DGD' products from DGD website or authorized distributor of their products the permission to return product that is defective to DGD for discretionary repair based on the type of failure. Failure of products cannot be exacerbated by the end user and failures must be under normal use with proper installation by a certified, experienced installer for which this warranty covers. Should a defective product be found, installation costs incurred to install remove and troubleshoot the device will remain solely with the end user and DGD will not be responsible for these or associated costs with the exception of the defective product in question. Repair, replacement or exchange costs for defective products will be the responsibility DGD in addition to shipping costs associated with shipping the unit back to the customer but not from the customer. Any external costs DGD is not responsible for. In the case of Loss, theft, misuse, neglect, accidents, alterations, defacement, shipping – DGD cannot be held responsible for the above end user imposed damage to its products. Customers in shipping areas prone to loss, theft, damage should request shipping insurance to be added at cost the user, installer, distributor or dealer. Liability to DGD for repair or exchange will not exceed the MSRP of the product in question and thus limited to that cost. This warranty is limited to a time period no greater than 12 months from the original date of purchase from DGD. This warranty exists for iKey unit and not the vehicle or user. Repaired units or exchange units are covered from the date of return to the user for the duration not exceeding 12 months. This warranty is in lieu of all other DGD warranties or liabilities. Warranty claims by the user or installer must be submitted within a period of 18 months of the date of purchase. The product in question must be discovered damaged or defective within 12 months of purchase for warranty eligibility however a claim must be submitted within 18 months of the date of purchase. Dealers/Installers/Distributors: The above applies to customers of DGD authorized 3rd Party sellers which are defined as end users of the above parties. The above parties may provide an extended warranty provisions or add other warranties however DGD is not a party to these provisions and thus not responsible for any warranties extended beyond this warranty. The above parties will not decrease, shorten, mitigate nor void this warranty provided by DGD to the end user. DGD cannot provide a warranty guarantee of functionality, installation, shipping delivery or merchantability between the end user and the above parties. Users are encouraged to work directly with these parties. DGD will within reason, make attempts to ensure its products are merchantable for its distributors/installers/dealers. Product damaged through shipping, abuse, neglect, alteration, mishandling, accident, defacement or "act of God" is not the responsibility of DGD. Defective or DOA product will be replaced/repared at no cost to the above parties with the exception of freight to DGD repair center of which the above parties are responsible for. Freight will be paid by DGD for repaired/replaced product back to the above parties. Customers that have purchased from the above parties are eligible for a 12 month warranty however must work with above parties of which they purchased the unit from to determine warranty eligibility. DGD will assist its direct customers. Warranty Return: To determine if your unit is eligible for repair contact the representative you purchased the unit from and request warranty repair/exchange. If you cannot reach your sales representative then please contact DGD for a Repair Authorization number. You will require date and proof of purchase and description of the defect. Do not send units for repair without an approved warranty claim.

**Very, Very, Very
Important**

Please take 5 minutes to register your product.

You must register online to activate
your product warranty and be eligible
for 24/7 Emergency Hotline Assistance

Go to:

www.DGDwarranty.com

FCC COMPLIANCE

This device has been tested and found to comply with Part 15 of the FCC Rules. Operation is subject to the following two conditions: (1) this device may not cause harmful interference, and (2) this device must accept any interference received, including interference that may cause undesired operation. The manufacturer is not responsible for any radio or TV interference caused by unauthorized modification to this equipment and such modifications could void the user's authority to operate the equipment.



DIGITAL
Guard Dawg

KEYLESS FOR ANYTHING YOU RIDE OR DRIVE

**1079 Sunrise Ave suite B-326
Roseville, CA 95661**

877-246-5395

www.DigitalGuardDawg.com